

FRONT BODY PILLAR (CUT)

REMOVAL

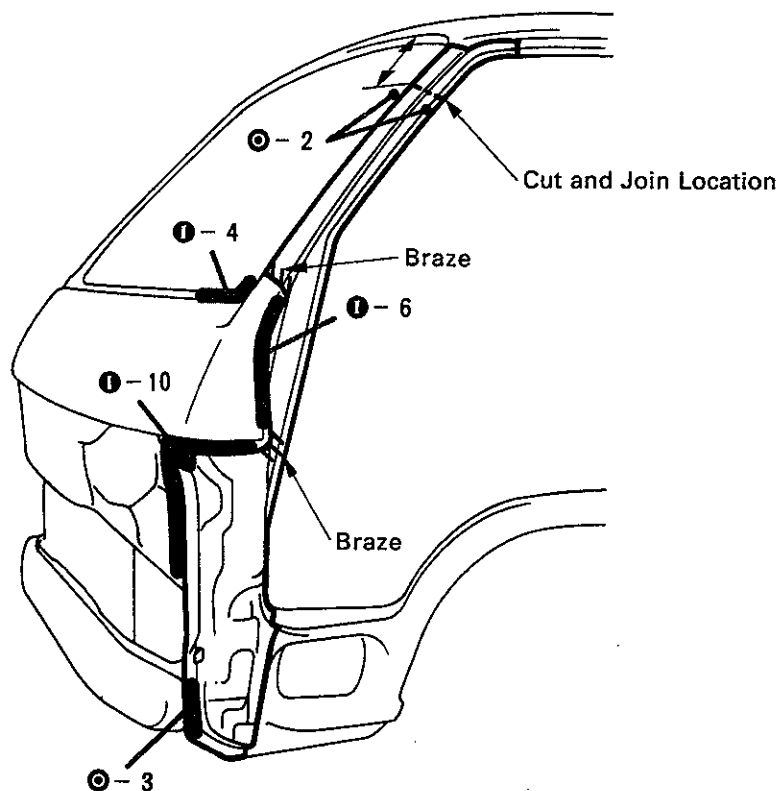

[Cut and Join Location]

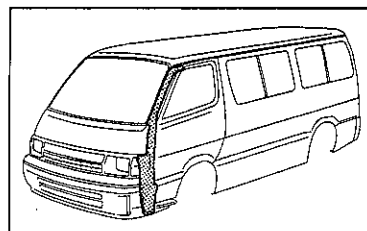
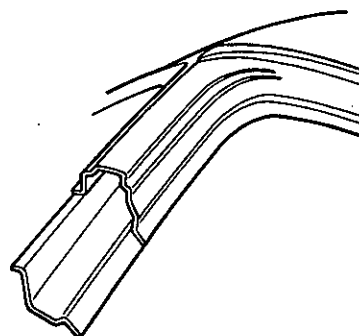

[View from Interior]

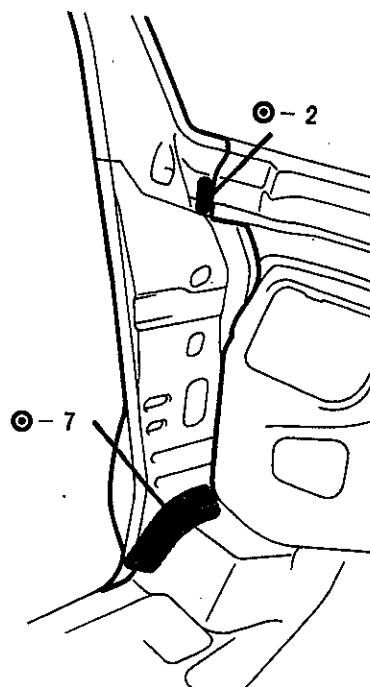
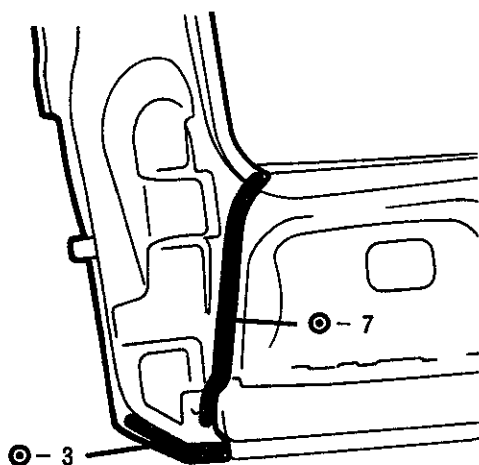

1. Cut and join the parts at the locations shown above.

- 3) Before cutting, remove the antenna cord.

NOTICE:

- 1) Avoid the antenna installation hole for the cut and join location.
- 2) As shown above, cut and join the front body pillar outer and inner at position shifted above 50 mm (1.97 in.).

INSTALLATION

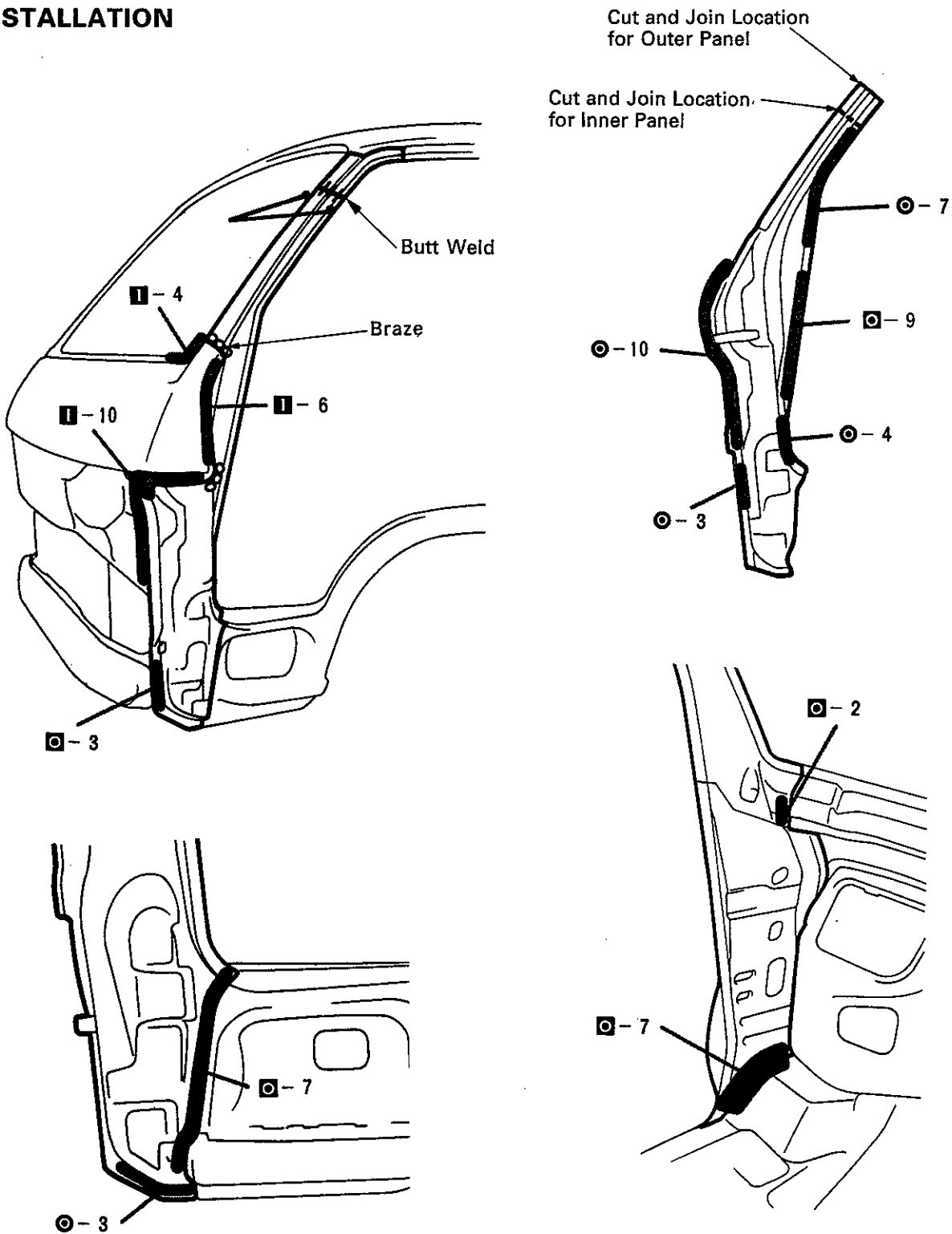

1. Before temporarily installing the new parts, weld the outer and inner panel at the standard points.
2. Temporarily install the new parts and check the fit of the front door and windshield glass.